

The SP60/80 Heavy Duty roller blind system can be controlled by chain, motor or crank. Its chain control is designed to lift blinds of up to 25 kg while maintaining a strong pull force of less than 3 kg. The motors can be controlled by wall switch; remote control or Building Management System (BMS).

## General information

Minimum blind width (chain control)	350mm
Minimum blind width (motorised)	745mm
Maximum blind width (SP60)	3500mm
Maximum blind width (SP80)	4000mm
Maximum blind drop	7000mm
Linking blinds	up to 3
Bend link	up to 90°
Duo blind system	allowing installation of two sets blinds in the same window
Retrofit spring assist booster	for easy lifting of heavy blinds
Total Block	fully enclosed aluminium cassette box and side channels
Automation	controlled by wall switch, remote or BMS



# Technical information

## SP60 bracket dimensions

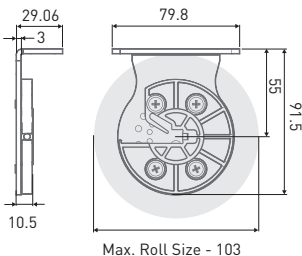

## SP80 bracket dimensions

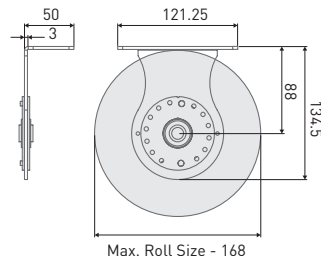

## Duo bracket dimensions

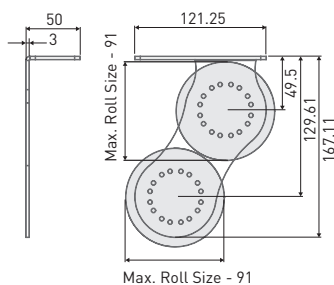

## Linked blinds deductions

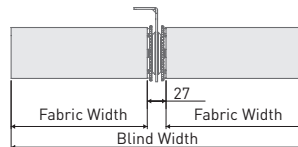

## Deductions from window measurements

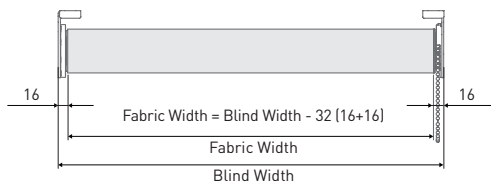

# Specifications

## Brackets

- Press formed steel, pre-treated and powder coated
- Top and face fix
- Colours: white; black

## Head tube

- Extruded aluminium
- Diameter: 60mm; 80mm

## Base Bar

- Extruded aluminium
- Type: linear; oval; square; round
- Colours: anodised; white; bone; sandstone; barley; dune; bronze; black; custom painted

## Chain control

- Direct action, dual reverse clutch
- Colours: white; black

## Idler

- ABS, nylon & acetal with steel roller bearings
- Safety lock metal pin on square shaft
- Colour: white; black

## Motorisation

- 240V tubular motors
- Silent motors
- Controls: wall switch; remote control; BMS