

# EXTERNAL WIRE GUIDE INSTALLATION MANUAL

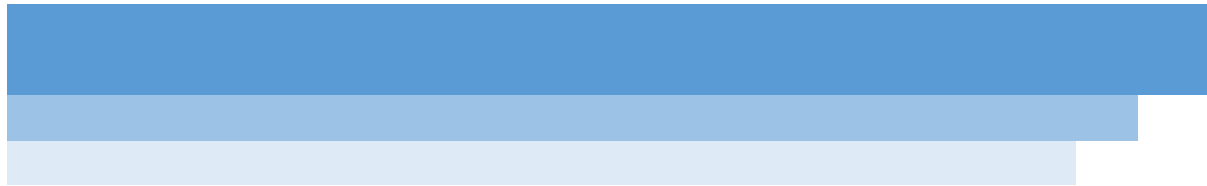

September 2013

# CONTENTS

September 2013

This manual is to be read in conjunction with the Product Specifications & Assembly manual

SECTION NO.	DESCRIPTION	PAGE NO.
<b>SECTION 1 – ITEMS REQUIRED</b>		<b>1.1</b>
<b>SECTION 2 – INSTALLATION</b>		<b>2.1</b>
	PART A – PREPARING INSTALLATION SPACE	2.1
	PART B – BRACKET / BOX INSTALLATION	2.3
	PART C – WIRE GUIDE INSTALLATION	2.4
	PART D – BLIND INSTALLATION	2.8
	PART E – BOX COVER INSTALLATION (FOR BOX 120 SYSTEM ONLY)	2.10
	PART F – TENSION GUIDELINES	2.12
<b>SECTION 3 – TROUBLESHOOTING</b>		<b>3.1</b>

## DISCLAIMER

### INTRODUCTION

This Installation manual has been produced by Acmeda to supply the necessary information for safe and correct installation of this system.

### INSTALLERS RESPONSIBILITY

Before installing, please read & ensure you understand the safety information and installation instructions as defined in this installation manual.

- If you do not fully understand these instructions, contact Acmeda for clarification before installing.
- The Installer is responsible to ensure that all installation personnel have been adequately trained on the safe & correct installation and operation.
- The Installer is responsible to ensure that a Job Safety Analysis or Safe Work Method Statement is completed prior to installation to identify hazards, to determine appropriate risk control measures and to implement the control measures.
- The Installer is responsible to ensure that supporting structures are sound and can adequately support the load.
- The Installer is responsible to ensure that the devices used to anchor the product to the supporting structure are suitable for the application.

### SAFETY INFORMATION

- Ensure Job Safety Analysis/Safe Work Method Statement is completed and actions to reduce risks are implemented.
- Ensure that electrical works are done only by a LICENSED ELECTRICIAN.
- DO NOT modify any of the components of this system.

### PERSONNEL REQUIREMENTS

Only suitably trained/qualified personnel should undertake installation.

### DISCLAIMER

Acmeda has used reasonable care in preparing the information included in this document, but makes no representations or warranties as to the completeness or accuracy of the information. Information is supplied upon the condition that the persons receiving the information will make their own determination as to its suitability for their purposes prior to use. Acmeda assumes no liability whatsoever for any damages incurred by you resulting from errors in or omissions from the information included herein. Acmeda reserves the right to make changes without further notice to any products to improve reliability, function or design.

### COPYRIGHT

COPYRIGHT © ACMEDA 2013

All rights reserved. No part of this document may be reproduced or utilised in any means, by any means, electronic or mechanical including photocopying, recordings, or by any information storage or retrieval system, without the express permission from Acmeda.

## SECTION 1 – ITEMS REQUIRED

### TOOLS REQUIRED

- Saw
- Saw
- Drill
- Screw Driver – Philips Head & Flat Head
- Jaw Pliers
- Allen Key Set
- Mallet
- Scissors
- Punch tool / template
- Measuring Tape
- Pencil

### ADDITIONAL ITEMS REQUIRED (NOT SUPPLIED)

To assemble an EXTERNAL WIRE GUIDE, the following non-stocked items are required:

- Fixings for mounting brackets / hardware (Ensure appropriate fixings are used to suit application)

## BLIND ITEMS REQUIRED

Check that you have all required blind items:

1. Brackets
2. Box Square 120 + Required Installation Items
3. Complete Blind
4. Wire Guide Components

### 1. Brackets

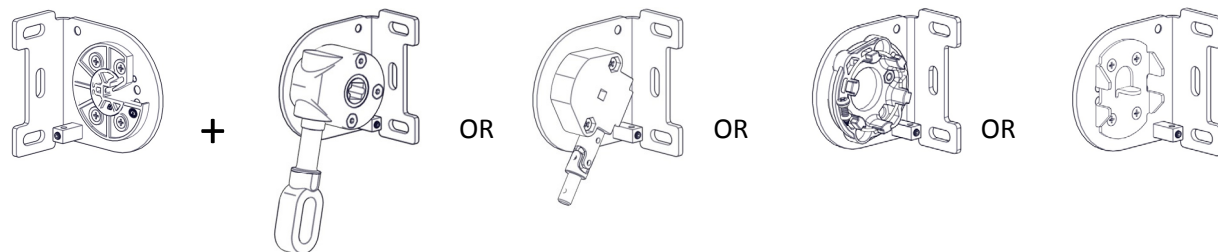

### 2. Box Square 120 + Required Installation Items

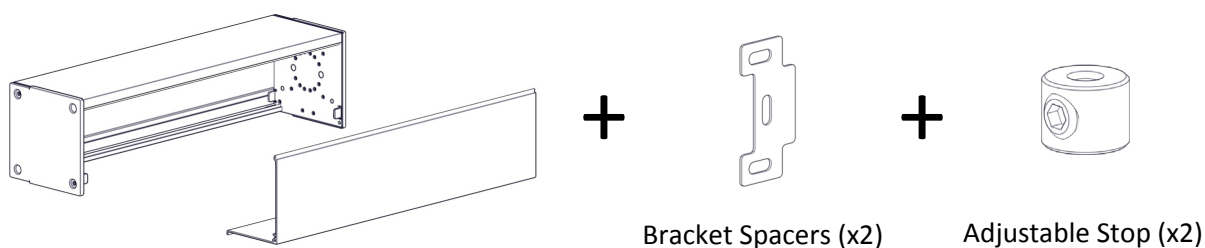

### 3. Complete Blind

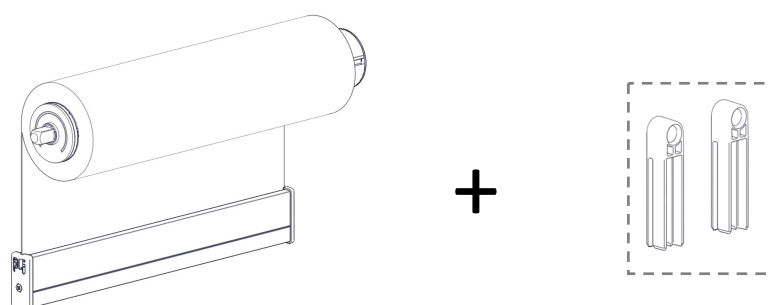

### 4. Wire Guide Components

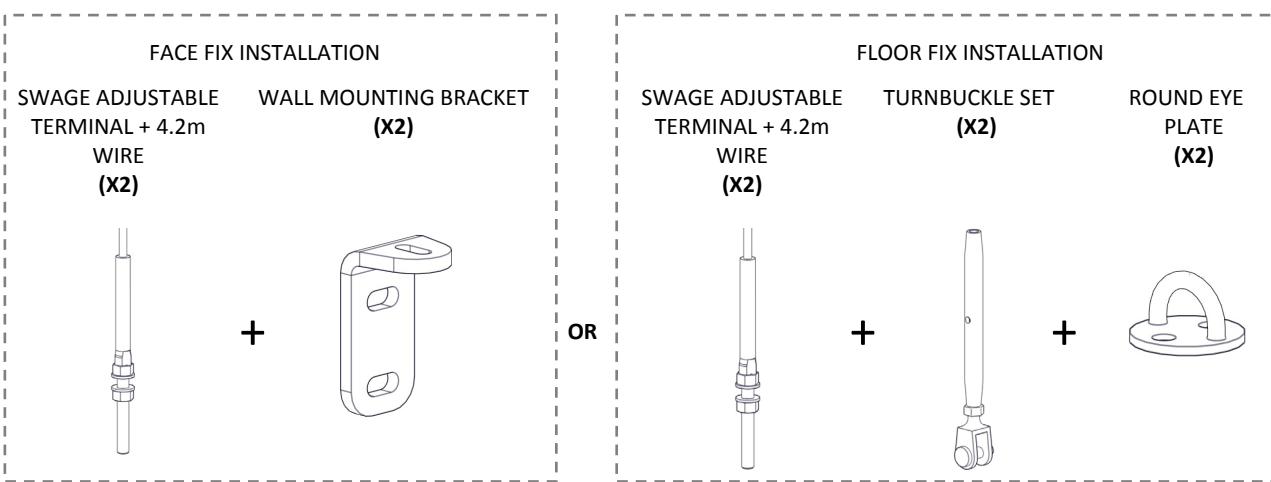

## SECTION 2 – INSTALLATION

### PART A – PREPARING INSTALLATION SPACE

#### STEP 1 – CHECK INSTALLATION SPACE FOR CLEARANCE & STRUCTURAL SUPPORT

Check the Installation Space and ensure adequate clearance is provided for the system

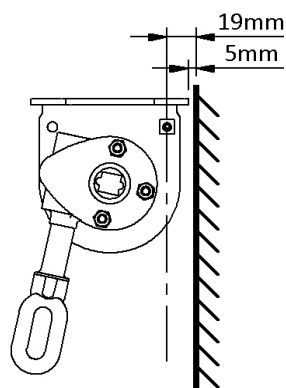
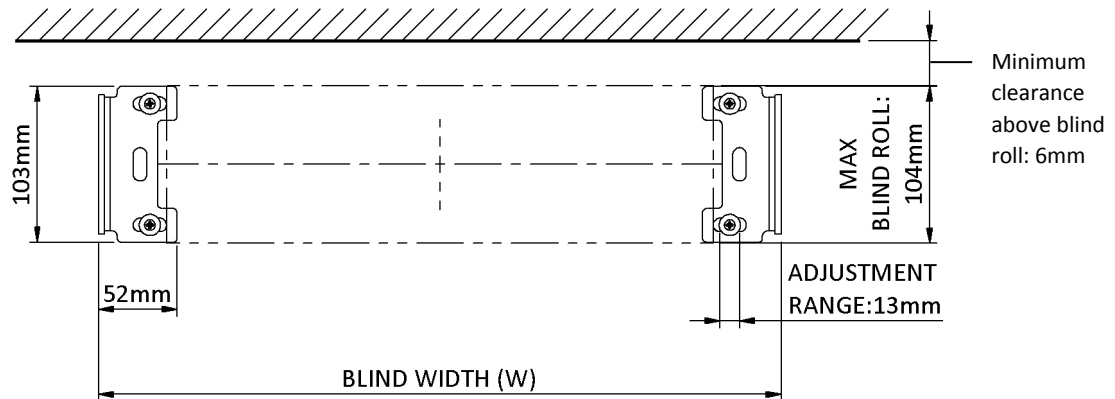

NOTE: For Top Fix Installations allow 5mm from the wall to the edge of the bracket to provide clearance for weight bar end caps.

Ensure brackets can be installed into a structurally supporting substrate (This may mean the installer needs to prepare space prior to commencement of installation)

## STEP 2 – CHECK VERTICAL & HORIZONTAL INSTALLATION DIMENSIONS

### VERTICAL DIMENSIONS

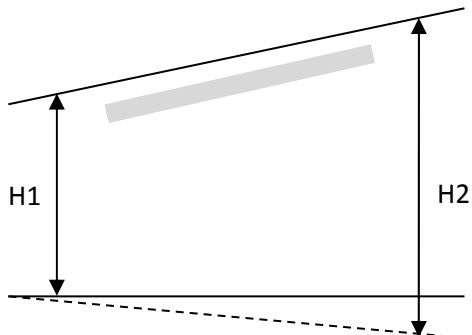

Check if top of installation space is level.

- If  $H1 \neq H2$ , corrective actions may need to be considered prior to installation

### HORIZONTAL DIMENSIONS

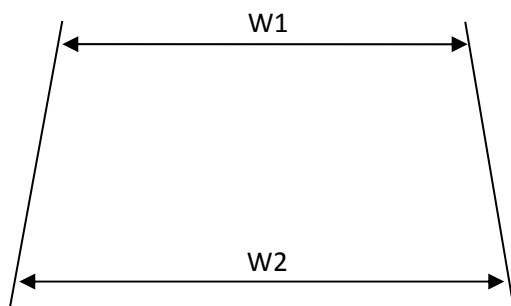

If  $W2 \geq W1$ ,  $W1 = \text{Blind Width}$   
(proceed to Section C)

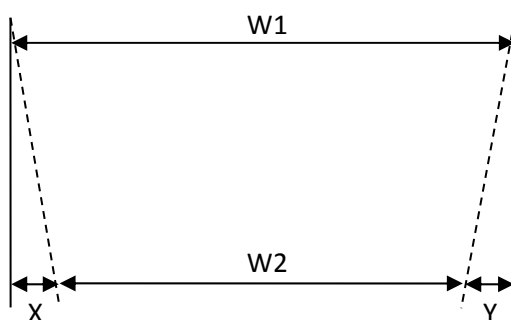

If  $W2 < W1$ , see table for limits

Maximum width difference		
	Box 120	Open
X	16mm	10mm
Y	16mm	10mm

If X and Y are within limits (as indicated in the above table) then installation can be completed using  $W1$  as Blind Width.

If not consider further actions for squaring the installation space (e.g. packing or alternative bracket selection)

## PART B – BRACKET / BOX INSTALLATION

### STEP 1 – FIX BRACKETS TO WALL / CEILING USING APPROPRIATE FIXINGS TO SUIT APPLICATION

#### OPEN BLIND SYSTEM

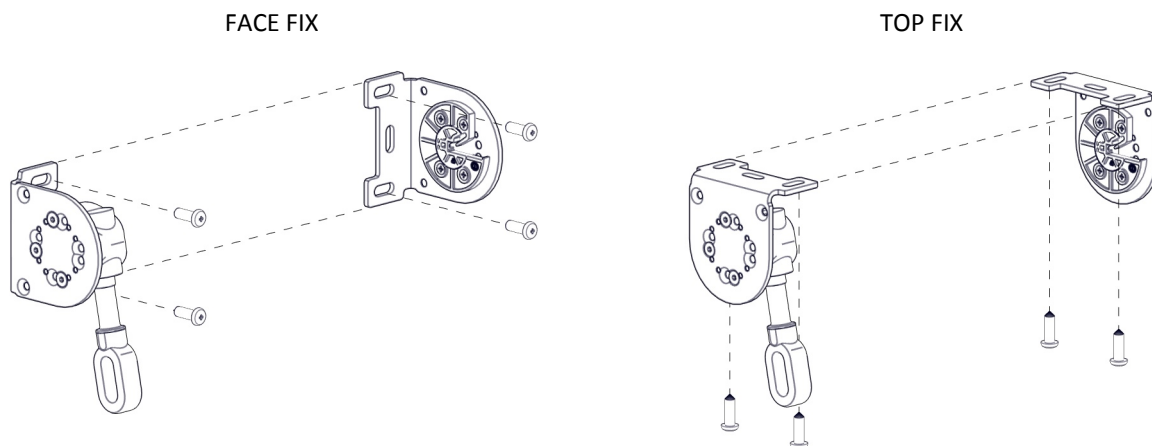

NOTE: Ensure brackets are installed aligned and level. Refer to deductions for bracket positioning.

#### BOX 120 SYSTEM

Box 120 System can be fixed to the wall in the centre prior to fixing the brackets to ensure Box is level.

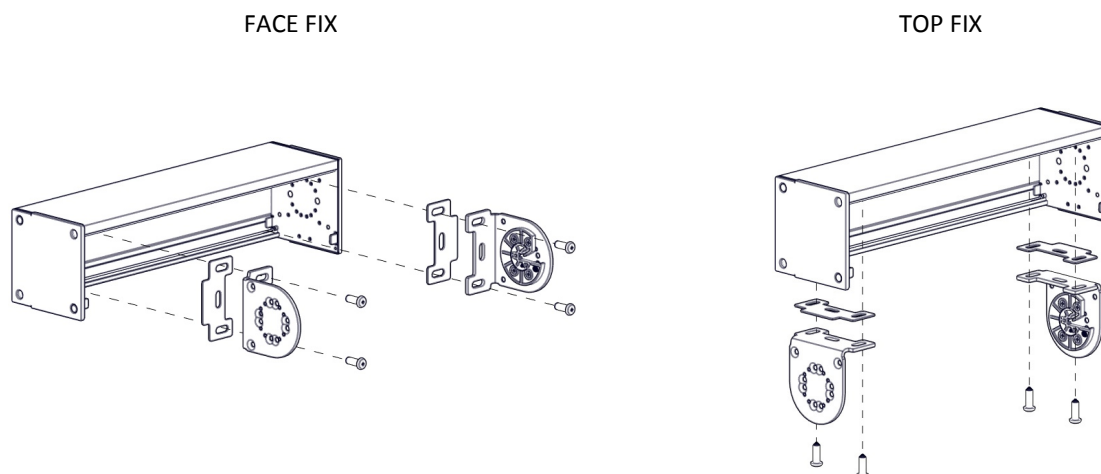

NOTE: Ensure Bracket Spacers are used with Box 120 System

## PART C – WIRE GUIDE INSTALLATION

### STEP 1 – MARK & SECURE BOTTOM WIRE GUIDE FIXING TO WALL OR FLOOR

#### OPEN BLIND SYSTEM

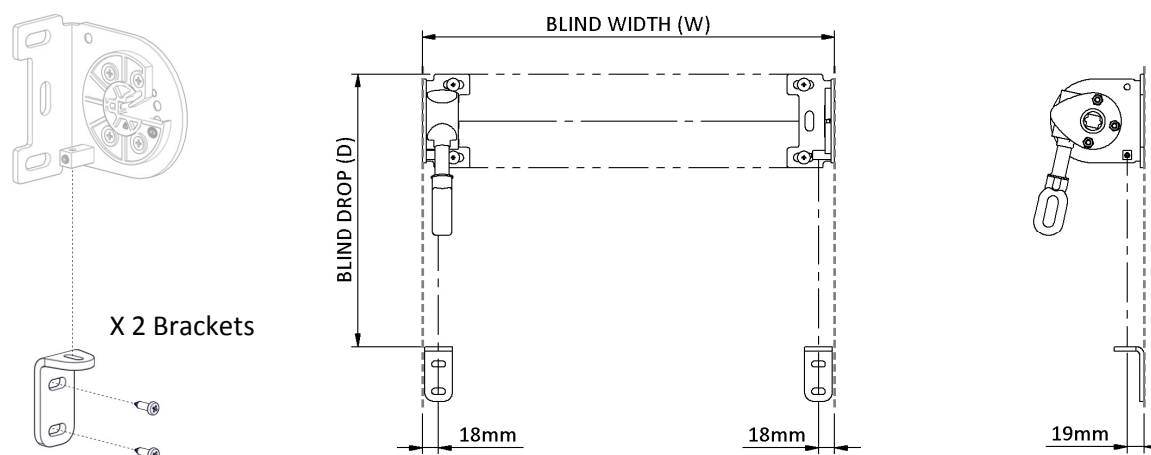

NOTE: Dimensions refer centre of wire and apply to both Face Fixing and Floor Fixing installations.

#### BOX 120 SYSTEM

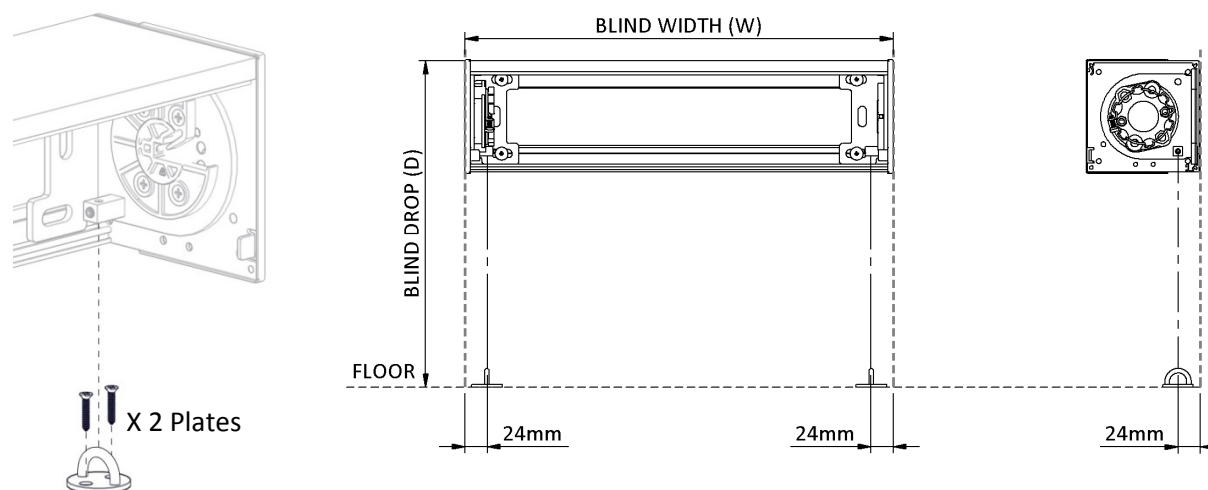

NOTE: Dimensions refer centre of wire and apply to both Face Fixing and Floor Fixing installations.



## STEP 2 – ATTACH TERMINAL TO WALL MOUNTING BRACKET

### FACE FIX - WALL MOUNTING BRACKET

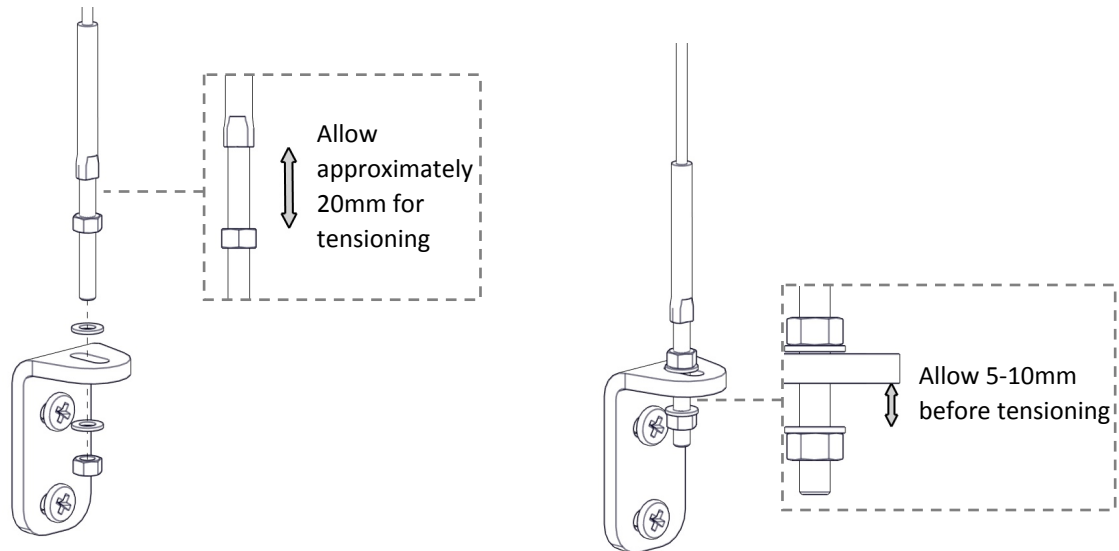

NOTE: Ensure both Terminals are attached to brackets.

### FLOOR FIX - ROUND EYE PLATE

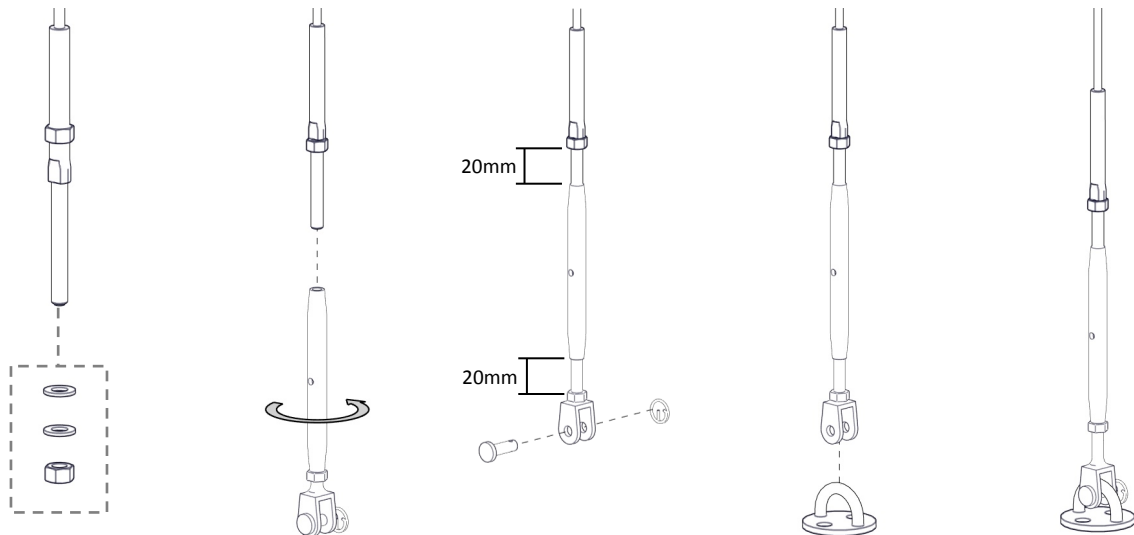

i) Remove 1 Nut & 2 Washers From Stud Terminal

ii) Thread Turnbuckle Set onto Terminal

iii) Remove Pin & Clip

iv) Position Jaw over Round Eye Plate

v) Replace & Secure Pin & Clip

NOTE: Ensure both Terminals are attached to Round Eye Plates.

### STEP 3 – INSERT WIRE GUIDE FLOAT ONTO WIRE

Feed Floating End Cap onto Wire (at both ends)



Allow End Cap to Slide along wire

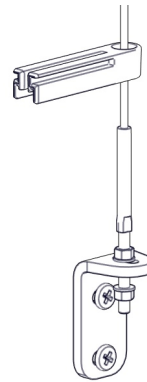

NOTE: Repeat on opposite side.

### STEP 4 – ADD ADJUSTABLE STOP (FOR BOX 120 SYSTEM ONLY)

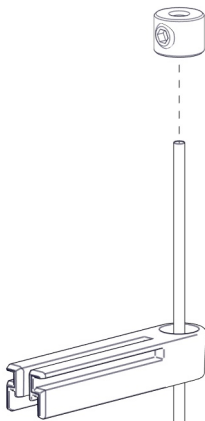

#### NOTES:

- Ensure Adjustable Stop is inserted after the Wire Guide Float.
- Do not tighten at this step
- Repeat on opposite side

#### STEP 5 – SECURE WIRE TO TOP TERMINAL

Insert Wire through terminal

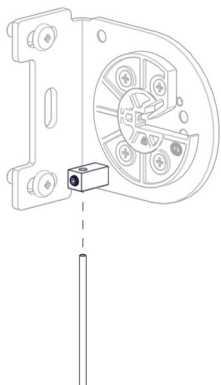

Measure & cut wire approximately 5-10mm above terminal

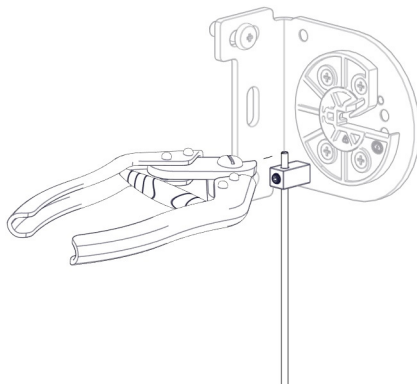

Tighten grub screw securely to retain wire (ensure thread of grub screw does not strip)

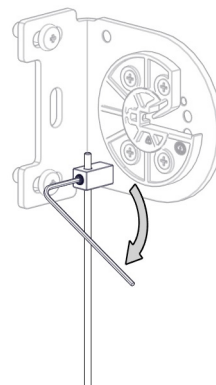

#### STEP 6 – ADJUST & SECURE ADJUSTABLE STOP TO WIRE GUIDES (FOR BOX 120 SYSTEM ONLY)

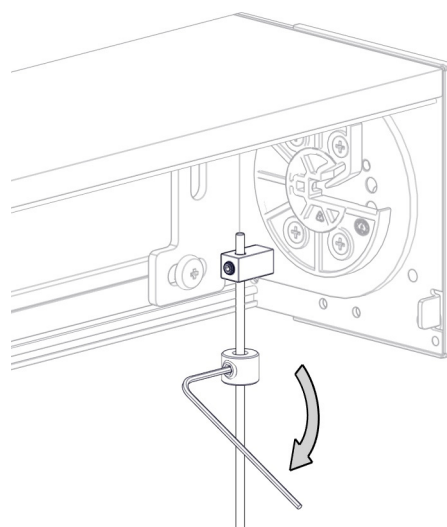
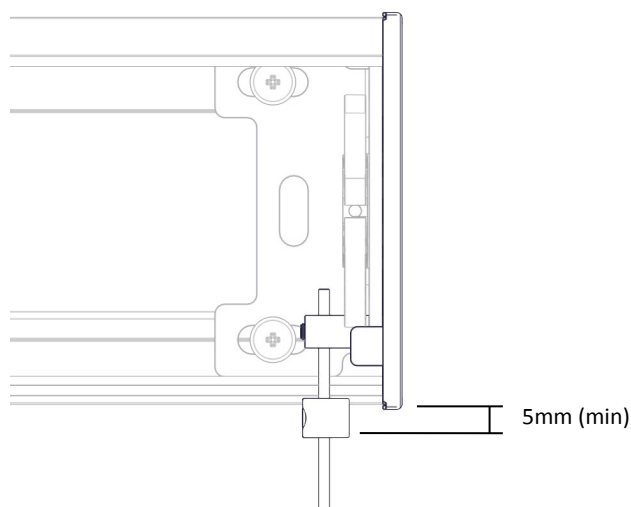

NOTE: Ensure that a minimum clearance of 5mm is left between the bottom of the Adjustable Stop and bottom of the Box to prevent the weight bar from twisting.

## PART D – BLIND INSTALLATION

### STEP 1 – INSERT CONTROL END FIRST THEN SWING IDLER END INTO ADAPTOR

#### GEAR CONTROL

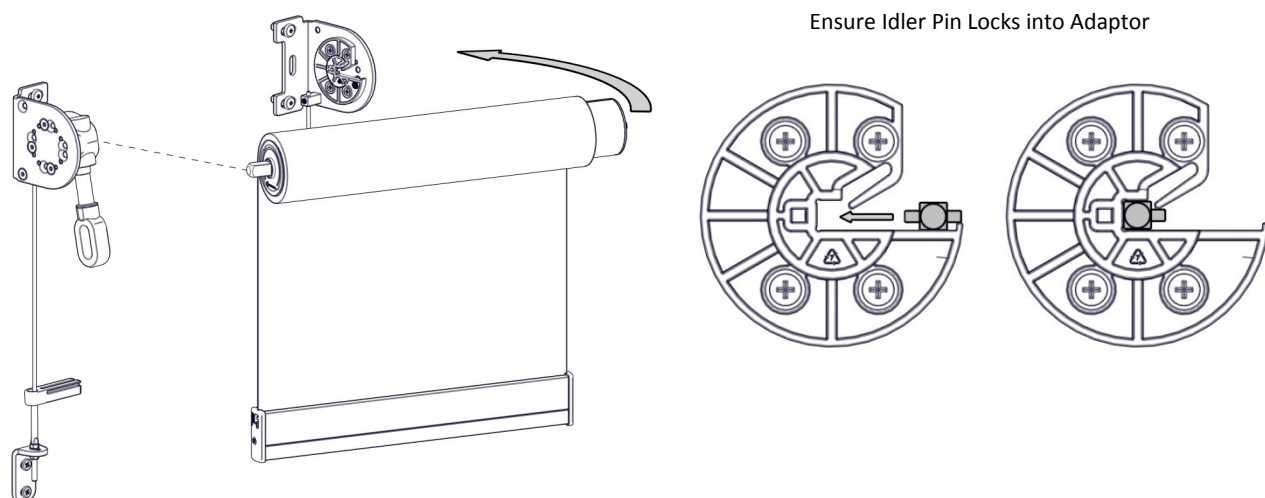

#### STAR HEAD MOTOR (FOR STAR HEAD MOTOR ONLY)

Remove retaining screw from the lock ring before inserting blind as shown above.

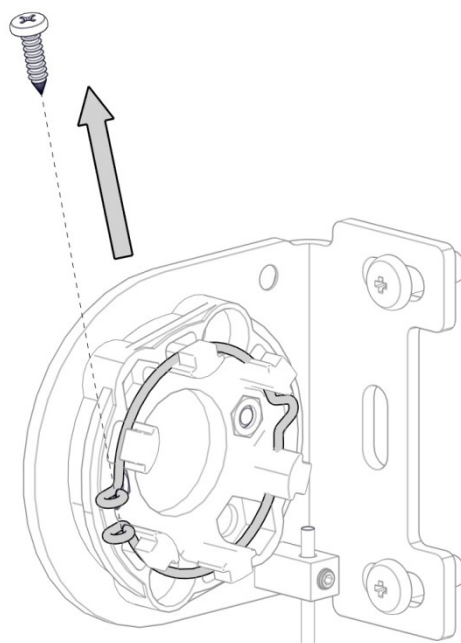

NOTE: Ensure screw is safely stored as it will need to be re-inserted.

## STEP 2 – REPLACE & SECURE RETAINING SCREW INTO LOCKING RING (STAR HEAD MOTOR ONLY)

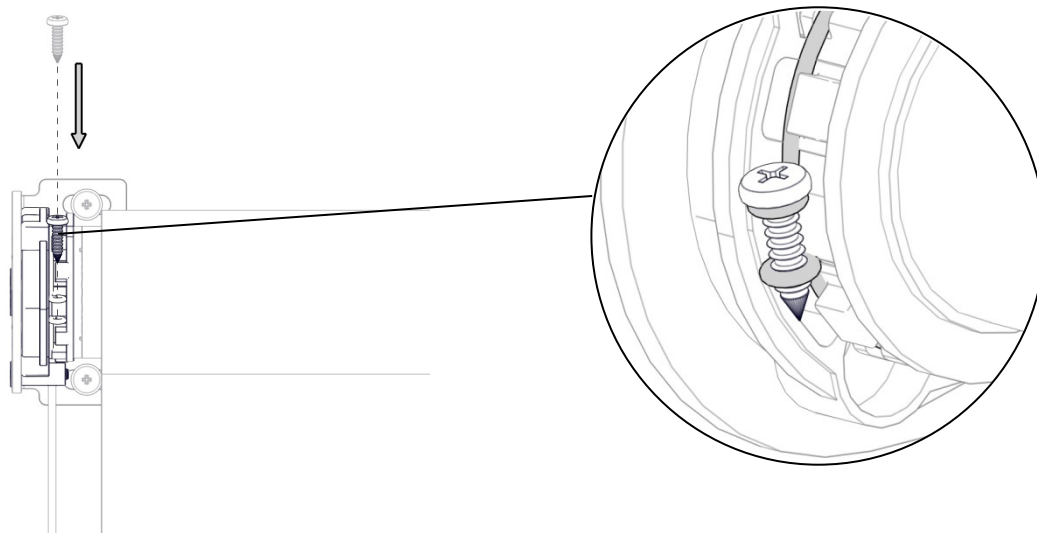

Screw until tight in order to lock the Motor in position

## STEP 3 – INSERT FLOATING END CAPS INTO END CAP HOUSING

Before applying tension to wire guides, insert end cap float into weight bar end caps.

If more clearance / space is required, lift the weight bar at one end to insert the second float.

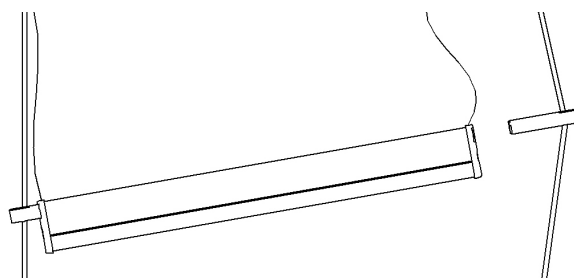
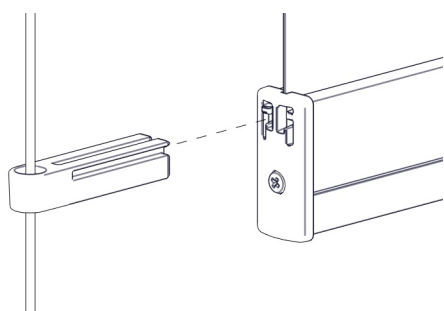

### NOTE:

If ballast is required, insert prior to fitting end cap. For external applications ensure ballast is corrosion resistant and is compatible with aluminium.

## PART E – BOX COVER INSTALLATION (FOR BOX 120 SYSTEM ONLY)

### STEP 1 – SWING BOX COVER INTO PLACE

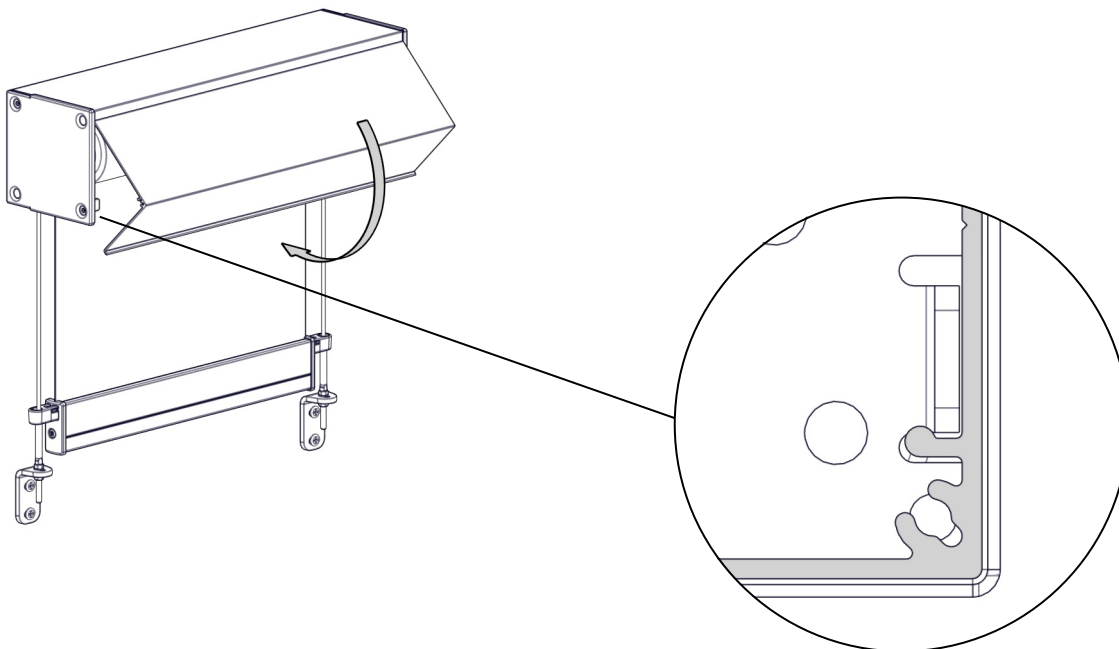

Ensure Cover clips to tab

IF the lip of the cover is not location use a pair of pliers to adjust the locking feature up or down as required

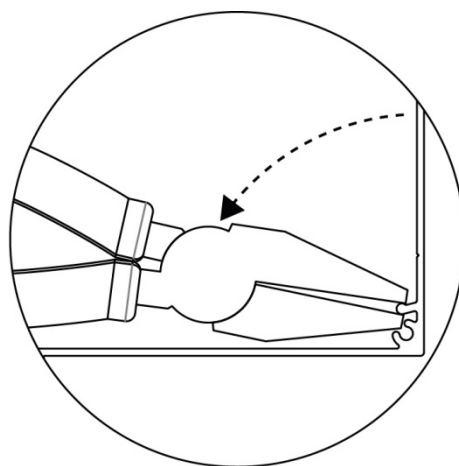
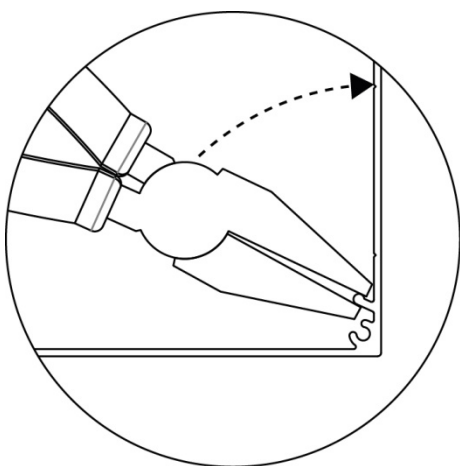

**STEP 2 – FIX COVER WITH SCREW OR RIVET (OPTIONAL)**

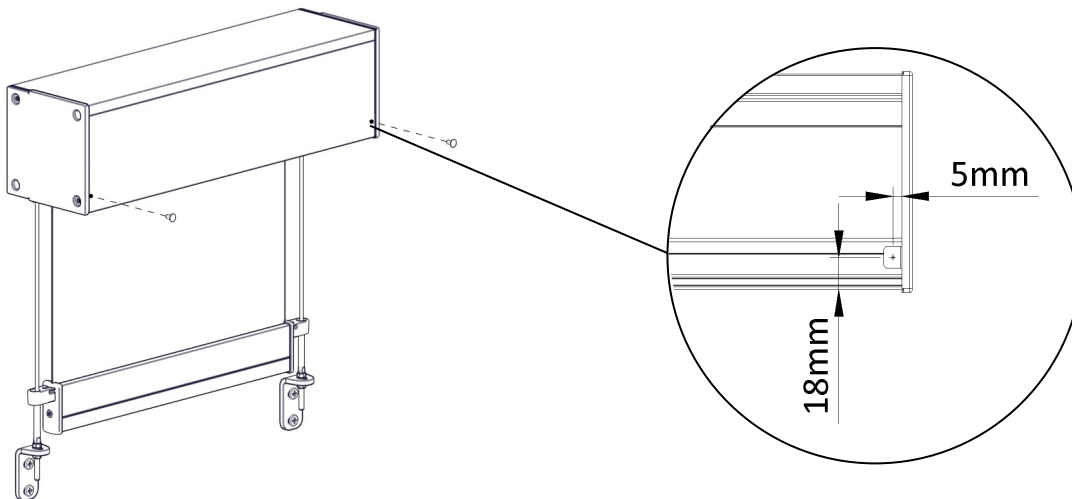

## PART F – TENSION GUIDELINES

To complete the installation ensure adequate tension is applied to the wire guides. 40kg of tension is recommended for the system. If a suitable tension meter is not used, the chart/images below provide a guide on how to apply a nominal tension of 40kg

**Tension Guideline Table**

Drop	No. of Rotations (Face Fix)	No. of Rotations (Floor Fix)
1.0m	1	0.5
2.0m	2	1
3.0m	2	1
4.0m	3	1.5

### FACE FIX

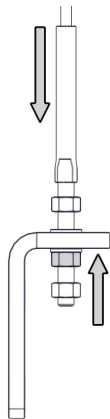

**1.** Pull Swage Terminal down to remove slack and hand tighten bottom nut until contact with bracket

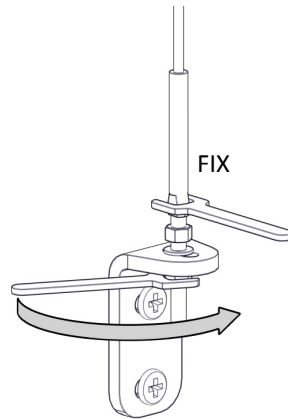

**2.** Apply tension by holding Swage Terminal still and rotating bottom nut as required (No. Of Rotations indicated above)

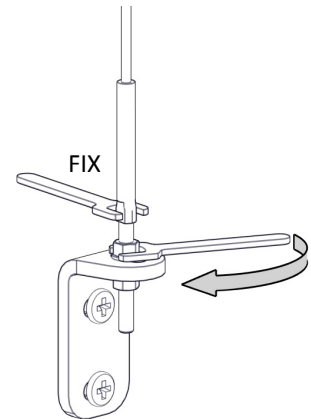

**3.** Tighten and lock top nut while supporting Swage Terminal to ensure tension is maintained (repeat on other terminal)

NOTE: Repeat on opposite side.

### FLOOR FIX

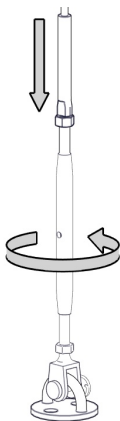

**1.** Pull Swage Terminal down and hand tighten Turnbuckle to remove slack

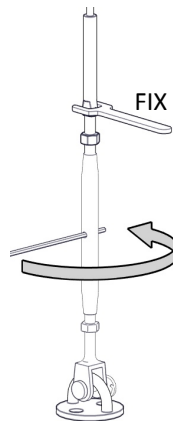

**2.** Apply tension by holding Swage Terminal and rotating Turnbuckle as required (No. Of Rotations indicated above)

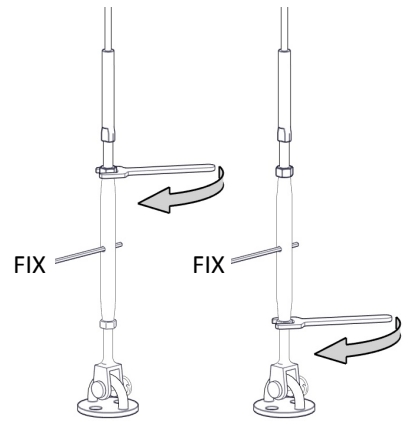

**3.** While holding the Turnbuckle Secure both top and bottom nuts to ensure the system is locked (ensure to only lock one at a time)

NOTE: Repeat on opposite side.

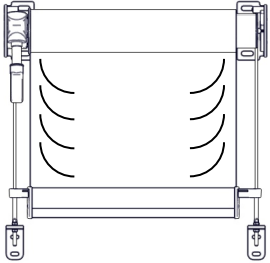
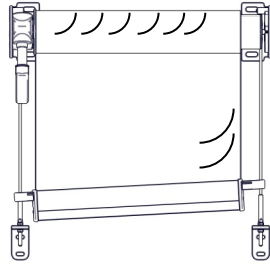

## SECTION 3 – TROUBLESHOOTING

NO.	PROBLEM	CAUSE	SOLUTION
1	<p>Ripples along sides of fabric</p> 	Blind rolled up for an extended period of time.	This occurrence is inherent to roller systems and is more prevalent in some fabrics. Leave blind down for 1 – 4 hours; most ripples should disappear.
		Not enough weight in weight bar.	Refer to Product Specs. Add ballast.
		Installation is not square.	Check blind roll is installed level.
		Fabric permanently damaged due to inadequate handling during assembly, transportation, installation or use.	Replace fabric and ensure it is handled with care.
2	Blind does not fully open / jams	Position of wire guides at base is incorrect.	Check if wire guide fixing at floor/base are positioned in line with the Top Terminal. If fixing is too far inwards of the terminal then reposition. Refer to Part C, Step 1 of this document for wire guide positioning details.
		Incorrect motor stop limits used.	Refer to motor instructions to reset stop limits.
3	<p>Uneven weight bar</p> 	Blind roll is not level, thus weight bar appears uneven.	Ensure blind is installed level.
		Blind has been operated in excessive wind conditions.	Check blind roll when the blind is fully raised. If ripples are evident on roll, open blind fully (without the presence of wind) to allow the blind to track down evenly. Raise and lower blind a number of times to check operation.
		Fabric is not installed straight.	Ensure fabric is assembled straight onto tube and weight bar.